

This universal mechanical-operated plier MG[®] 130 is an all-purpose stapler for all stapling jobs such as carton blanks, telescope-type boxes, slide lids, carton trays, carrying handles etc. By-pass legs ensure a high level of strength. The legs lie flat and the tips are bent back into the cardboard. This means safety for people and contents!

It is a dependable branded stapler with a long service life and will help you do your job at all times provided you take into account the following observations:



It is the customer's responsibility to have all operators and service personnel read and understand this manual. Prior to use please read these operating instructions carefully.

1. At any malfunction stop working with the stapling plier. Do not try to clear jams by force. Consult operating manual and repair cautiously.
2. Clean the stapler regularly and lubricate the friction points now and then.
3. Unauthorized modifications or improper repairs are not allowed for safety and product liability considerations. In case fault cannot be cleared please take contact with the manufacturer for repair.
4. Only **Original staples MG[®]130** as laid down in the specification may be used to avoid malfunction. Depending upon the carton quality, the following staples MG[®] 130 (crown size 13 mm), with different leg lengths can be inserted:

MG[®] 130/10 with 10 mm leg length

MG[®] 130/12 with 12 mm leg length

MG[®] 130/16 with 16 mm leg length



Loading the magazine:

1. Take grip of staple pusher, press slightly inside, make a small rotation to the left and pull staple pusher out backwards from the magazine.
2. Put staple strips onto the staple carrier now visible and slide them into the magazine.
3. Insert staple pusher again. Make sure the smooth surface at locking grip is on top. Press grip completely inside and lock by a small rotation to the right.

Trouble Shooting:

Staples and staple remainders can easily be ejected by pressing down the hand lever. In most cases this will already clear the jams. Should this action not be successful, do not force, but please take

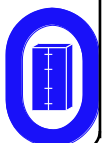

one of the following procedures:

In any case take out the staple pusher (17) first.

1. Pull down front plate (18) at staple outlet. In case the staple pusher has not been taken out before by mistake, the two laminated springs – at long as they are still turned in – will prevent the staples from jumping out.
2. Swing out laminated springs to the left and to the right.
3. Now clean the open staple channel from jamming staples by sliding the staple pusher all the way through the channel.
4. Swing back laminated springs into their initial position and slip on front plate.
5. If this does not help, loosen catch (20) and take out bolt (19).
6. Pull out the magazine to front. The staple channel is now also accessible from above and can be cleaned from any sticking staples.
7. After clearing insert the magazine (22) from ahead into the stapling plier so that the steel bolt (4) in the front meets to the hole of the driver blade (16) and the hinge to the hole of the housing. Insert stud (19) and screw it with the catch (20).

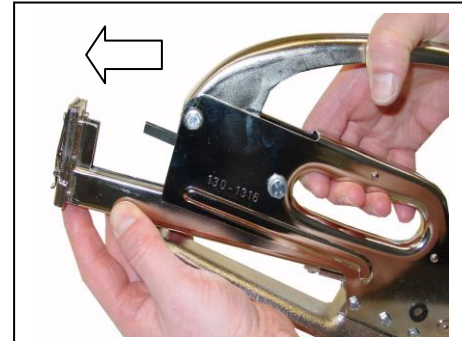
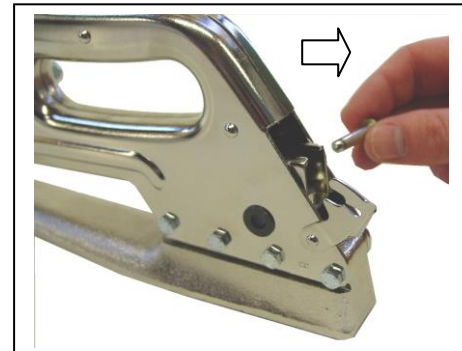
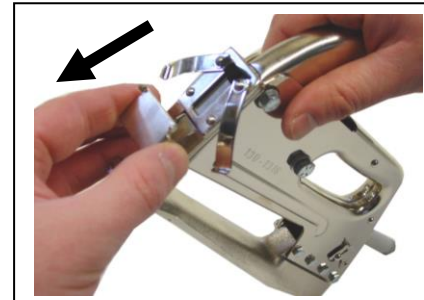

Please note that all parts subject to wear and tear are tempered to guarantee a long service life. All friction points should be oiled slightly now and then. Only load the stapling plier when it is empty.

Technical Data:

Stapling plier Throat Weight Dimensions L x W x H

MG[®] 130/1916 19 cm 1,550 g 265 (480*) x 35 x 200 mm

Loading capacity: 100 staples = 2 strips MG[®] 130.

Loading capacity*: 250 staples = 5 strips MG[®] 130
 (extended magazin*)



The stapling plier 130 is also available with 25 mm sword and in a pneumatic version.

For stationary application we recommend our Side Arm or SGR Stapling Machines.

